

Price list and characteristic
Superstudio
Výstaviště Praha Holešovice
Right Wing of Industrial Palace
in Prague

25. – 29. 10. 2018
Designblok '18

Superstudio description

The 20th Designblok – the most important design event in Central Europe – will present installations open to both professionals and the general public at The Industrial Palace (Průmyslový palace) at Výstaviště Praha (The Prague Exhibition Grounds). A historic site originally built to host exhibitions, the grounds were once host to the most significant exhibitions in Czech industry and design. Now, by agreement with the City of Prague, Designblok will bring its creativity and experience to add even more prestige to this venue, which has over the years seen its grounds damaged not only by the Communist administration but also as a result of the unfortunate events that took place in the wake of the Velvet Revolution. Located in the Industrial Palace at the Prague Exhibition Grounds in Holešovice, the Superstudio will take up residence at this attractive venue, famed for its beautiful architecture and grand opulence. The Superstudio will provide the space appropriate for the needs of each exhibitor. The sizes of the individual exhibition spaces can be tailored to the exhibitors' request, creating the ideal environment for showcasing the latest trends in contemporary lifestyle and design.

The Industrial Palace, with its impressive design, has always sparked much emotion and debate. The palace was built in 1891 in the heart of the Exhibition Grounds in Holešovice, where a remarkable robust structure was erected and later gradually filled with glass. Designed by architect Bedřich Münzberger, the steel structure stands over fifty metres high and is famous for being the first mounted steel structure to be built in the Czech lands. Constructed by První Českomoravské Strojírny-Kolben-Daněk in Prague, it was completed by 150 ironworkers over 5 months. The style of the Industrial Palace is considered Art Nouveau by many experts, although others tend to describe it in terms of "historicism". Side facades were fitted with windows, themed to depict motifs from Industry and Science, painted originally on carton board by Mikoláš Aleš and made from gold and yellow cathedral glass. Around one million colourful leaded glass panes were used to create the different figures. The dome bears a large replica of a crown and cross representing the Crown of St Wenceslas. The interior was redesigned by architect Josef Fanta in 1907.

Individual installations by Designblok participants will be located in a special exhibition structure designed by Jan Rosický (Atelier 69), highlighting the exceptional architecture of the Superstudio while providing exhibitors with the flexibility and space to present their exhibitions. Larger installations will be presented in the magnificent main hall and the building's right wing. Aside from its exceptional location, the history and atmosphere attached to this historic building are sure to make this an exceptional event for both visitors and exhibitors alike. And with the Openstudio providing an exhibition space for designers located in the left-wing tent area, Designblok visitors will get ample opportunity to take in all Designblok events in the one spot.

Address: Výstaviště 67, 170 90 Praha 7 – Holešovice



Superstudio

Ground floor map and price list 2018:

Space No.	Price	Space No.	Price	Space No.	Price
P01	80 000 Kč	P25	48 000 Kč	P46	45 000 Kč
P02	76 000 Kč	P26	45 000 Kč	P47	45 000 Kč
P03	74 000 Kč	P27	35 000 Kč	P48	30 000 Kč
P04	98 000 Kč	P28	30 000 Kč	P49	45 000 Kč
P05	74 000 Kč	P29	45 000 Kč	P50	45 000 Kč
P06	75 000 Kč	P30	45 000 Kč	P51	45 000 Kč
P07	80 000 Kč	P31	45 000 Kč	P52	35 000 Kč
P08	76 000 Kč	P32	30 000 Kč	P53	45 000 Kč
P09	82 000 Kč	P33	45 000 Kč	P54	50 000 Kč
P10	76 000 Kč	P34	45 000 Kč	P55	35 000 Kč
P11	70 000 Kč	P35	45 000 Kč	P56	50 000 Kč
P12	100 000 Kč	P36	30 000 Kč	P57	65 000 Kč
P13	90 000 Kč	P37	45 000 Kč	P58	65 000 Kč
P14	100 000 Kč	P38	45 000 Kč	P59	55 000 Kč
P15	76 000 Kč	P39	45 000 Kč	P60	150 000 Kč
P16	76 000 Kč	P40	30 000 Kč	P61	100 000 Kč
P20	60 000 Kč	P41	45 000 Kč		
P21	69 000 Kč	P42	45 000 Kč	Module A	88 000 Kč
P22	69 000 Kč	P43	45 000 Kč	Module B	75 000 Kč
P23	50 000 Kč	P44	30 000 Kč	Module C	66 000 Kč
P24	35 000 Kč	P45	45 000 Kč		



Prices indicated are exclusive of VAT; energy consumption is included.

The reserved area cannot be let since it is booked for curated Designblok projects.

Superstudio Balcony map and price list 2018:

Space No.	Price
PG02	80 000 Kč
PG03	80 000 Kč
PG04	80 000 Kč
PG05	80 000 Kč
PG06	65 000 Kč
PG07	65 000 Kč
PG08	65 000 Kč
PG09	80 000 Kč
PG10	60 000 Kč

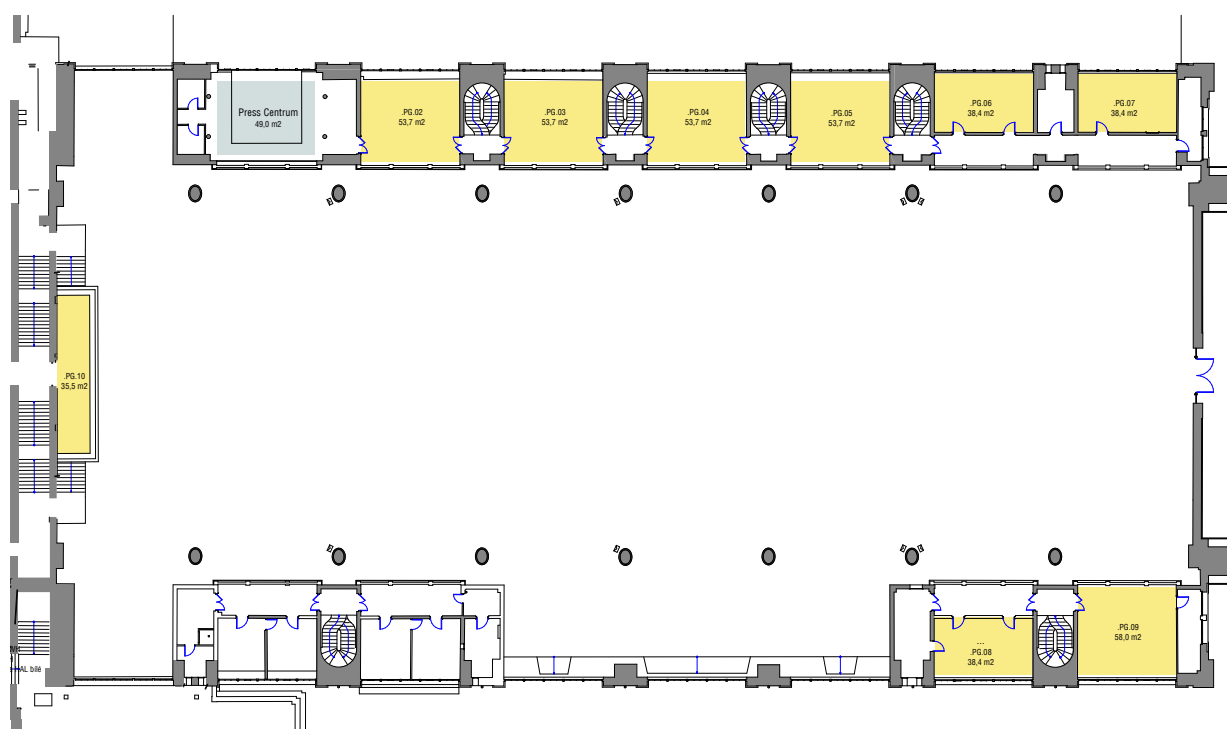

Prices indicated are exclusive of VAT; energy consumption is included.

The reserved area cannot be let since it is booked for curated Designblok projects.